

GoldRich PLANNERS & SURVEYORS LTD.

金潤規劃測量師行有限公司

Your Ref.: A/YL-KTS/1125

Our Ref.: P25012/TL26150

20 April 2026

The Secretary
Town Planning Board
15/F., North Point Government Offices
333 Java Road, North Point, Hong Kong

By E-mail
tpbpd@pland.gov.hk

Dear Sir,

Submission of Further Information (FI)

**Proposed Temporary Warehouse (excluding Dangerous Goods Godown)
With Ancillary Office and Associated Filling of Land for a Period of 3 Years in
“Agriculture” Zone, Lots 1012 S.B, 1012 S.C, 1013, 1014 RP, 1015 S.A, 1015 S.B,
1015 RP, 1016 (Part), 1018, 1034 (Part) and 1035 in D.D.113,
Kam Tin, Yuen Long, New Territories
(Application No. A/YL-KTS/1125)**

We write to submit FI in response to departmental comment(s) conveyed by the Planning Department for the captioned application.

Yours faithfully,
For and on behalf of
Goldrich Planners & Surveyors Ltd.



Francis LAU

Encl.

c.c.

DPO/FS&YLE, PlanD (Attn.: Ms. Athena LAI)

Further Information for Planning Application No. A/YL-KTS/1125**Response-to-Comments****Comments from the Antiquities and Monuments Office, Development Bureau**

Contact person: Ms. Kelly LAU (Tel.: 2208 4462)

I.	Comments	Responses
1.	As the application site is situated within the Ho Pui Site of Archaeological Interest, the applicant is required to confirm / clarify with the Antiquities and Monuments Office (AMO) whether there is any ground excavation proposed for the development including but not limited to site formation works, drainage works, sewerage works, construction of septic tank etc. If affirmative, the applicant is required to provide details of the proposed works, e.g. the location, extent and depth of the proposed ground excavation for AMO's further comment.	Ground excavation works is proposed for the 750 wide surface channel of a depth ranging from about 910mm to 1.58m along the site periphery of the application site to the satisfaction of the Drainage Services Department. Please refer to Plan 7 for the location, size and depth of the proposed drainage works for details.

- END -

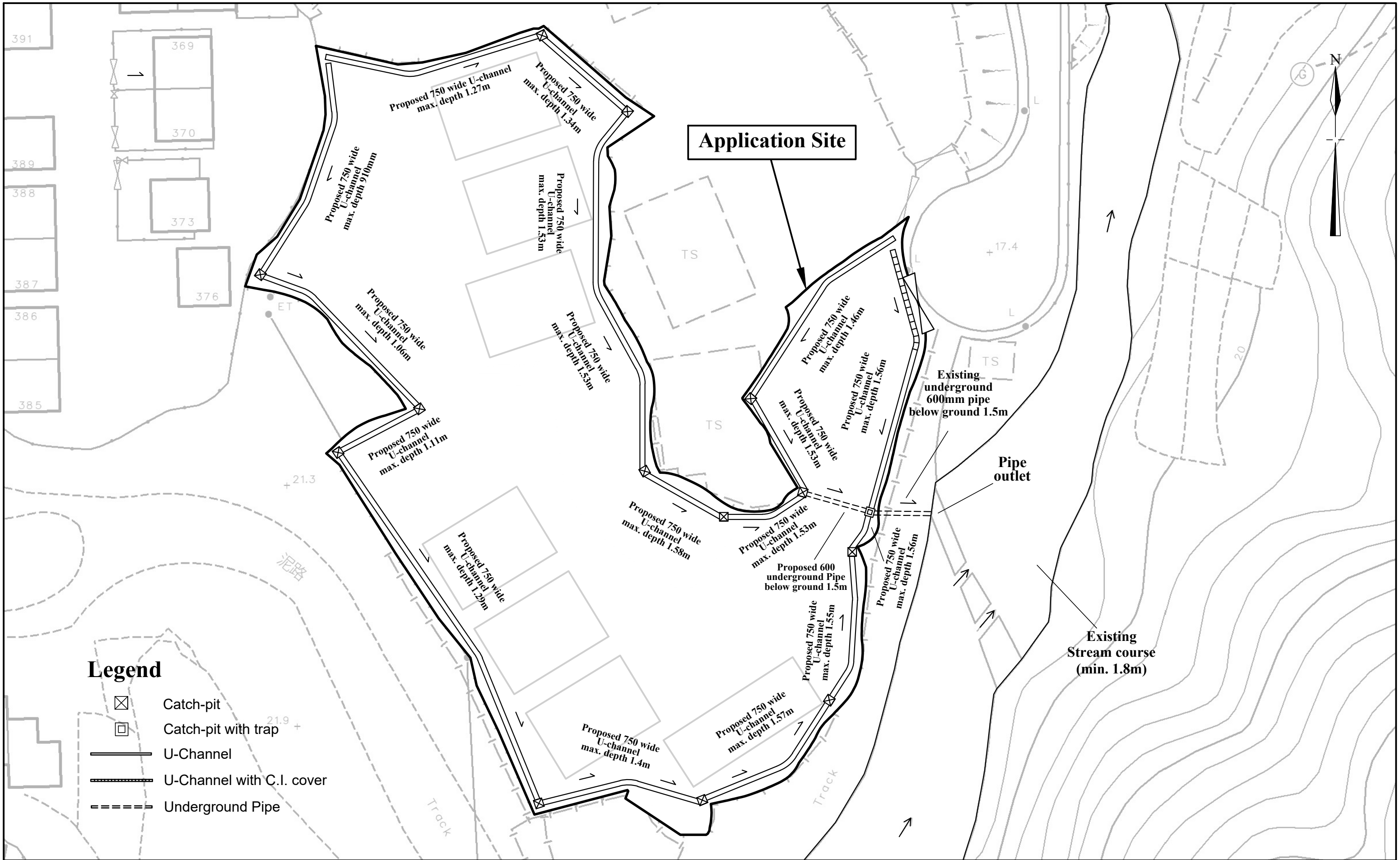

1:500 (A3)

April 2026

Plan Showing the Actual Situation of the Proposed Drainage Facilities on Site

Lots 1012 S.B, 1012 S.C, 1013, 1014RP, 1015 S.A, 1015 S.B, 1015 RP, 1016(part), 1018, 1034(part) and 1035 in D.D. 113 Yuen Long, N.T.

Goldrich Planners & Surveyors Ltd.

Plan 7 (P 25012)